

RGB LED Strip for Gaming Keypad

LTG076

UPLIFT DESK

Work better. Live healthier.

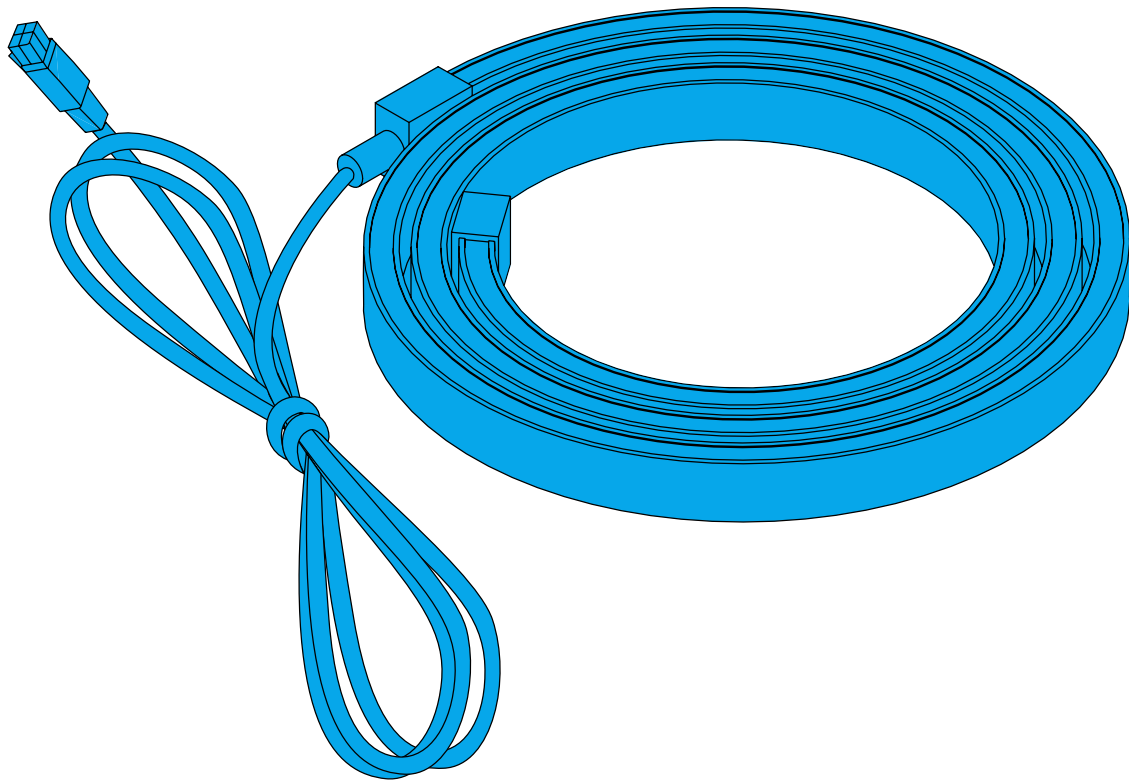

Scan QR code for
product webpage



Safety and Warnings

WARNING: Read all instructions before assembly. Failure to assemble or operate the product properly may result in damage. Retain this manual for future reference or new owners.

WARNING: Ensure all cords have enough slack so they don't pull as the standing desk moves up and down.

WARNING: The product is designed for indoor use only. Use outdoors or in damp locations can damage the product and can cause risk of electric shock and/or fire.

WARNING: Only plug the power adapter into a properly grounded 100-240V power outlet. Using a voltage converter is considered improper use and can cause damage to the product.

WARNING: Do not open or insert any object into the controller or power adaptor. Doing so may cause damage and can cause risk of electric shock.

WARNING: Never use the product if the power cord or plug becomes damaged to avoid risk of fire and/or electric shock. Contact UPLIFT Desk for a replacement power cord if it is damaged in any way.

CAUTION: In rare cases, certain light patterns may triggers seizures.

Packaging Components

LED Strip

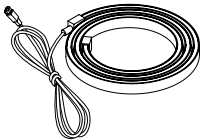

Additional LED strip sold separately (LTG076ES).

LED Controller

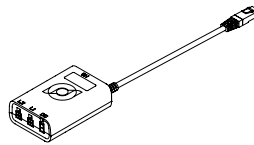

Power Adapter

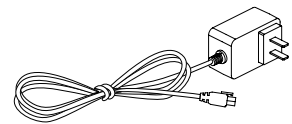

Adhesive Pad

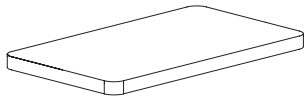

#10 x 5/8" Wood Screw

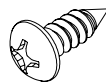

You'll also need



Phillips Screwdriver

Assembly Instructions

The RGB LED Strip is designed to be used in tandem with the Advanced RGB Gaming Keypad and UPLIFT Standing Desks.

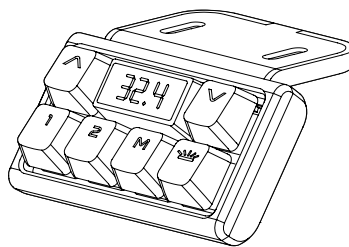

Advanced RGB Gaming Keypad (sold separately)

Step 1 - Inventory of Parts

Before discarding any packaging, lay out all the parts from each box and verify that every item listed in the package contents is present. If a part seems to be missing, check the boxes carefully to ensure it isn't there. If you confirm the part is missing, contact us at (800) 349-3839 or email support@upliftdesk.com before starting assembly.

Step 2 - Attach LED Strip

- A. Peel backing off of the LED strip and carefully place it in a desired location on the desktop. The location in the image below at the back of the desktop is one possible option. You may place it along the front edge of the desktop as well.

If you purchase an additional LED strip, you can place them at the front and back of the desktop.

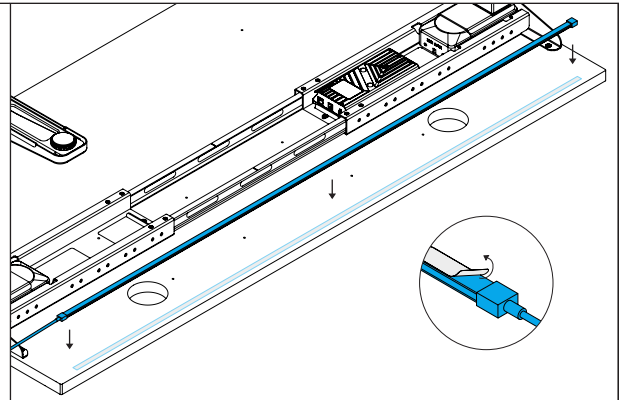

Step 3 - Attach LED Controller

- A. The LED Controller can be attached to the desktop or simply placed in the desk's cable manager.
- B. To attach it to the desktop, remove the backing from one side of the Adhesive Pad and stick it to the bottom of the LED Controller. Then remove the backing from the other side and stick the controller to the underside of the desktop near the desk's control box.
- C. To ensure the LED Controller does not come loose over time, secure it with a Phillips Screwdriver and the #10 x 5/8" Wood Screw.
- D. Attach LED Controller cable to "HS" port on control box.

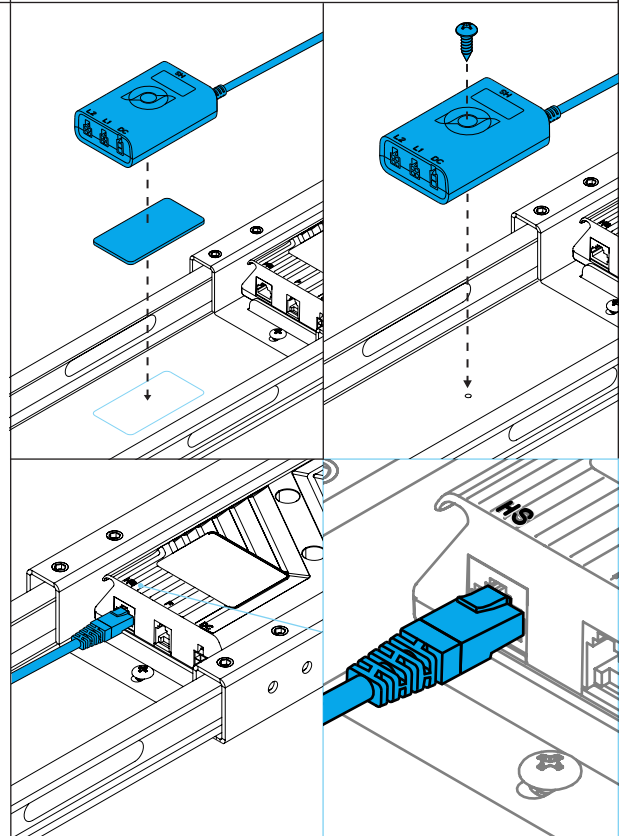

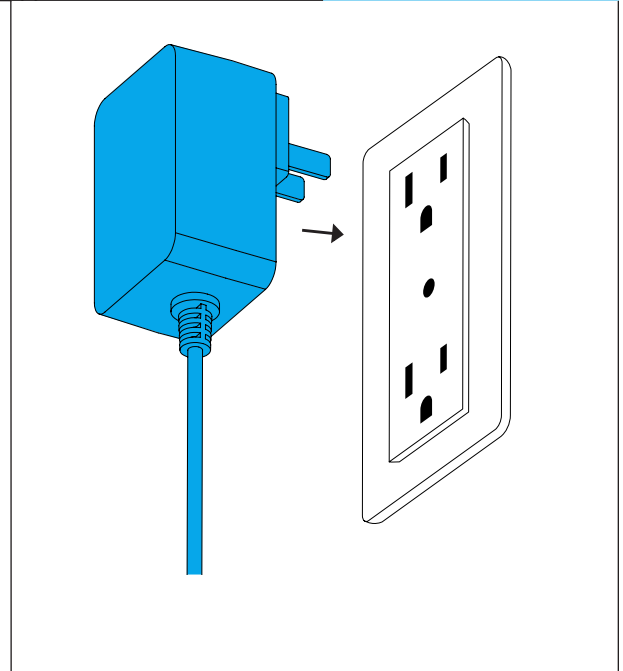

Step 4 - Power On

- A. Plug the Power Adapter into a power outlet.



Step 5 - LED Settings

A. Select the LED Pattern

- a. Press the  key to access the LED settings menu.
- b. Press the  key again to cycle through the numbered LED pattern options (L01-L07, L00 is off).
- c. Press the “M” key to save the pattern selected.

Note: If the “M” key is not pressed within about five seconds, the keypad will exit the settings menu without saving selections and return to the desk height display.

B. Select the LED Color (L01, L04, L05, L06, L07 LED single color patterns only)

- a. Press the  key to access the LED settings menu.
- b. Press the up arrow key to cycle through the color options.
 - (L01, L05, L06, L07) 42 color options
 - (L04) 3 white color temperature options
- c. Press the “M” key to save the pattern selected.

Note: If the “M” key is not pressed within about five seconds, the keypad will exit the settings menu without saving selections and return to the desk height display.

C. Select the LED Animation Speed (L02 & L03 LED color changing patterns only)

- a. Press the  key to access the LED settings menu.
- b. Press the up arrow key to run through the animation speed options below.
 - (L02) 600, 300, 60, 30, 15, and 5 second cycles
 - (L03) 300, 60, 30, 15, and 5 second cycles and cycle paused (- -)
- c. Press the “M” key to save the pattern selected.

Note: If the “M” key is not pressed within about five seconds, the keypad will exit the settings menu without saving selections and return to the desk height display.

D. Select the LED Brightness

- a. Press the  key to access the LED settings menu.
- b. Press the down arrow key to cycle through eight brightness levels (12.5% to 100%).
- c. Press the “M” key to save the pattern selected.

Note: If the “M” key is not pressed within about five seconds, the keypad will exit the settings menu without saving selections and return to the desk height display.

UPLIFT DESK

Work better. Live healthier.

upliftdesk.com

info@upliftdesk.com

800-349-3839

512-614-3152

For assembly assistance, visit upliftdesk.com/contact, or call 800-349-3839, or email support@upliftdesk.com
©2024 UPLIFT Desk®. All rights reserved.

SAVE THIS MANUAL

Study this manual carefully. If this product is sold, please provide this manual to the buyer, installers, or support personnel operating the product.



Copyright Notice: This manual is a component of this UPLIFT Desk product. This manual is a part of the scope of delivery, even if the item is resold. This manual is also available on the UPLIFT Desk website: upliftdesk.com. This manual is subject to United States copyright law.